



Mercedes E Class (W212) 2010-2013

* Left hand drive models only

Visit MetraOnline.com for more detailed information about the product and up-to-date vehicle specific applications

KIT FEATURES

- ISO DDIN radio provision
- Includes panel for relocating the factory buttons
- Painted black

KIT COMPONENTS

- A) Radio housing • B) Radio brackets • C) Button panel housing • D) Button panel housing bracket • E) Button panel tabs (2)
- F) Button extension harness • G) Radio screws (4) • H) 3/8" screws (8) • I) 1/4" screws (2)



TABLE OF CONTENTS

Dash Disassembly	2
Kit Preparation	3
Kit Assembly	4

WIRING & ANTENNA CONNECTIONS (sold separately)

Wiring Harness: XSVI-9005-NAV (non-amped only)
 Antenna Adapter: 40-EU10

TOOLS REQUIRED

- Panel removal tool • Phillips screwdriver
- T-20 Torx screwdriver • 3mm Allen screwdriver
- Thin-head flat-blade screwdriver

Attention! Let the vehicle sit with the key out of the ignition for a few minutes before removing the factory radio. When testing the aftermarket equipment, ensure that all factory equipment is connected before cycling the key to ignition.

DASH DISASSEMBLY

Radio/Button Removal:

1. Open the glove box, then pull down (2) clips securing the a/c vent panel above the glove box opening. (Figure A)
2. Locate the release clip inside each center a/c vent. Using a thin-head flat-blade screwdriver, pull out on the release clips to free the a/c vent panel. Unclip, unplug and remove the panel. (Figure B)
3. Unscrew (2) T-20 Torx screws on top of the radio/button assembly until they no longer turn easily, then pull them up as much as they can go. Gently pull on the radio to release it. If it doesn't release, slightly unscrew the screws again, and periodically pull on the radio/button assembly until the assembly releases. Slide the assembly out just enough to access the connector* on the bottom right side of the assembly. Slide the assembly out fully, then unplug and remove the assembly. (Figures C & D)

Note*: This connector will connect to the **button extension harness** discussed in **Kit Preparation**.



(Figure A)



(Figure B)

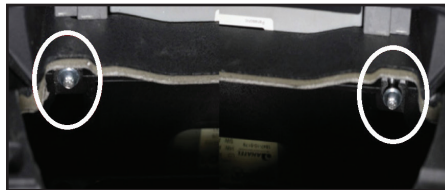

(Figure C)

Display Removal:

1. Unclip and remove the display bezel trim. There are (4) clips securing the trim to the display. Shown in the figure is the bottom left clip. (Figure E)

Continue to Kit Preparation



(Figure D)



(Figure E)

KIT PREPARATION

Button Relocation

1. Connect the **button extension harness** to the harness removed in step 3 from **Dash Disassembly**. Route this harness to the display area up top.
2. Remove the button panel from the factory radio:
 - a. Unclip the trim from the bottom of the radio.
 - b. Remove (4) screws securing the panel, then remove the panel. (Figure A)
3. Attach the button panel to the **button panel housing**:
 - a. Slide the button panel under the top lip of the housing, then click the bottom in place.
 - b. Secure the **button panel housing brackets** to the housing using (4) of the 3/8" screws provided. (Figure B)
 - c. Secure the **button panel tabs** to the housing using (2) 1/4" screws provided. Take note that the tab



(Figure A)

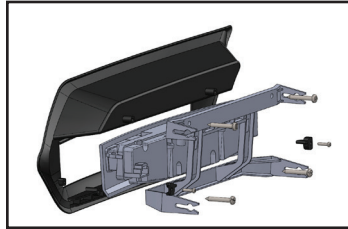

(Figure B)

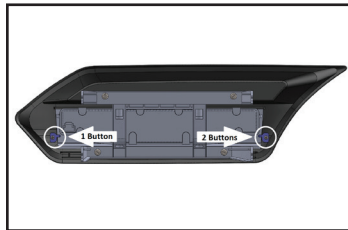

(Figure C)

closest to the driver side of the vehicle has (2) dots. (Figures B & C)

- d. Fully secure the button panel to the assembly using the factory hardware. (Figure D)
4. Connect the button panel to the **button extension harness** in the vehicle, then clip the assembly to the vehicle.

Housing Assembly

5. Secure the **radio brackets** to the **radio housing** using (4) 3/8" screws provided. (Figure E)

Continue to Kit Assembly

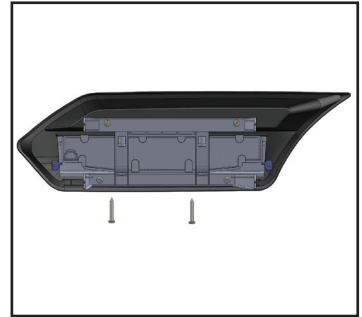

(Figure D)

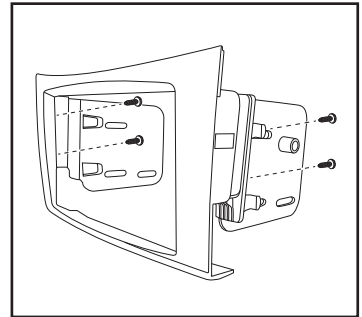

(Figure E)



KIT ASSEMBLY

1. Slide the radio into the **bracket/housing** assembly, then secure the radio using either the screws supplied with the radio, or the **radio screws** provided. (Figure A)
2. Locate the factory wiring harness and antenna connector in the dash and complete all necessary connections to the radio. Metra recommends using the proper mating adapter from Metra and/or Axxess. Test the radio for proper operation.
3. Slide the radio into the dash. Push the (2) T-20 Torx screws down, then tighten them to secure the radio to the dash.
4. Reassemble the dash in reverse order of disassembly to complete the installation.

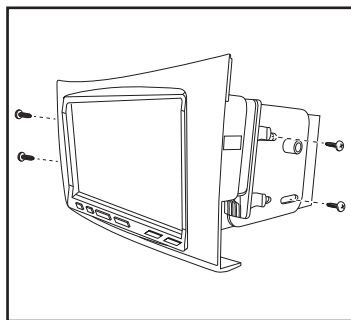

(Figure A)

If you are having difficulties with the installation of this product, contact our Tech Support line either by phone at **1-800-253-TECH**, or email at **techsupport@metra-autosound.com**. Before doing so, look over the instruction booklet a second time and ensure that the installation was performed exactly as the instruction booklet is stated. Have the vehicle apart and ready to perform troubleshooting steps before contacting Metra/Axxess Tech Support.



KNOWLEDGE IS POWER

Enhance your installation and fabrication skills by enrolling in the most recognized and respected mobile electronics school in our industry. Log onto www.installerinstitute.com or call 800-354-6782 for more information and take steps toward a better tomorrow.



Metra recommends MECP
certified technicians